

HYBRI-FLEX FLOORING

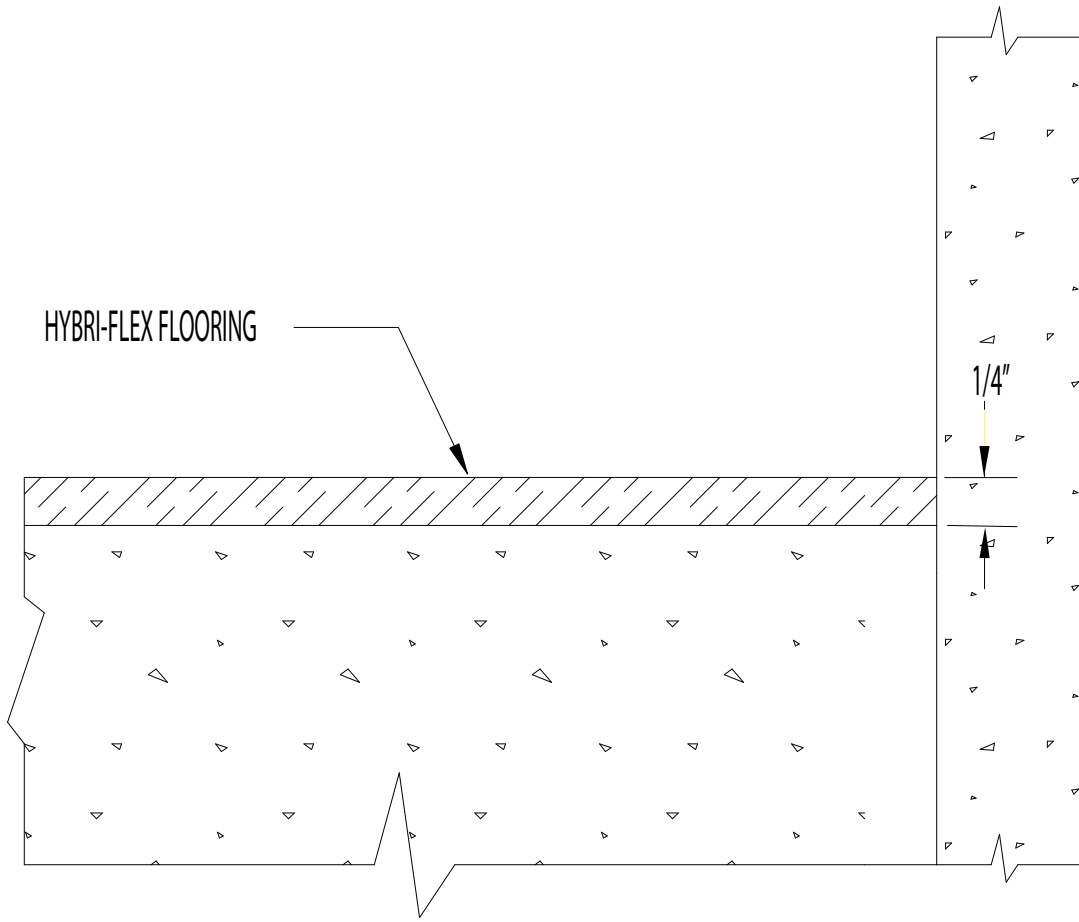

DUR-A-FLEX
INNOVATION FROM THE FLOOR UP

www.dur-a-flex.com

860-528-9838

TITLE

HYBRI-FLEX

FLOORING TO WALL, NO COVE BASE DETAIL

DATE

5/12

SCALE

AS NOTED

DWG NO.

HF-18

PROJECT